

4 3 2 1

1000
PSI

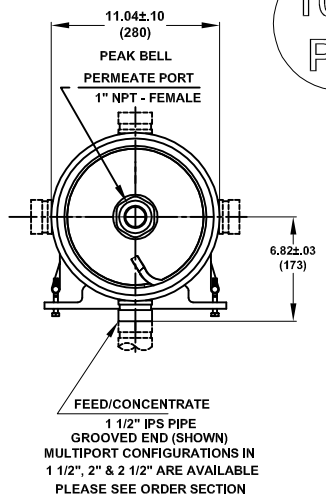
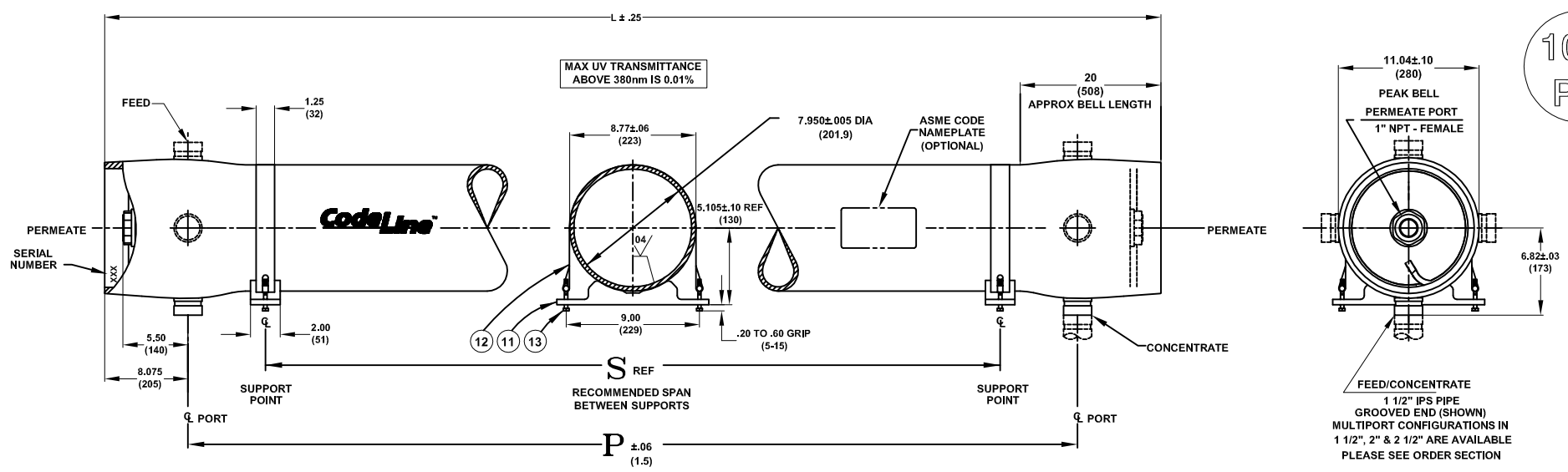

VIEW AT CENTER SUPPORT
CENTER VESSEL ON 2 OR 3 SUPPORTS AT SPAN(S) "S": 3 SUPPORTS REQUIRED FOR LENGTHS 4 AND OVER

CAUTION: INCORRECT MANFOLDING WILL CAUSE SEVERE LOCAL STRESS AROUND PORT AND MAY RESULT IN LEAKS AND PREMATURE FAILURE; TAKE EVERY PRECAUTION LISTED ON REVERSE, SEE INSTALLATION INSTRUCTIONS FOR FURTHER DETAILS

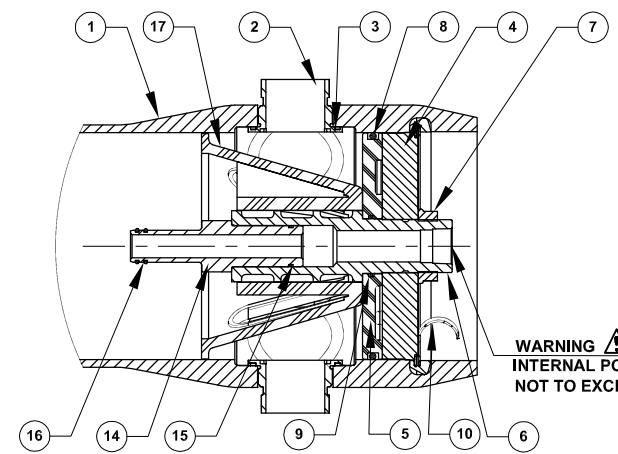

SECTION THROUGH END CLOSURE

- NOTES:-
- ♦ MAX. ANGULAR VARIATION BETWEEN ANY PORTS ±0.5°.
 - ♦ DIMENSION IN INCHES (MM APPROX.)
 - ♦ SHELL EXTERIOR COATED WITH WHITE, HIGH GLOSS POLYURETHANE PAINT.
 - ♦ NOT TO BE USED FOR CONSTRUCTION UNLESS CERTIFIED.
 - ♦ ITEM 17 DOWNSTREAM ONLY.
 - ♦ GRADE CD3MWCuN AS PER ASME SA-995 (J93380).

Dash Length	L IN(MM)	P IN(MM)	S IN(MM)	Approx Weight LB(KG)
-1	63.15 (1604)	47 (1194)	25X1 (635)	137 (62)
-2	103.15 (2620)	87 (2210)	56X1 (1422)	170 (77)
-3	143.15 (3636)	127 (3226)	80X1 (2032)	203 (92)
-4	183.15 (4652)	167 (4242)	64X2 (1626)	236 (107)
-5	223.15 (5668)	207 (5258)	78X2 (1981)	269 (122)
-6	263.15 (6684)	247 (6274)	92X2 (2337)	303 (137)
-7	303.15 (7700)	287 (7290)	106X2 (2692)	336 (152)
-8	343.15 (8716)	327 (8306)	120X2 (3048)	369 (167)

DWG REF	QTY	PART NUMBER	DESCRIPTION	MATERIAL
SHELL				
1	1	ORDER SECTION	SHELL	Filament Wound Epoxy/Glass composites - Head locking grooves integrally wound in place.
2	A/R		F/C Port	CD3MWCuN *
3	A/R		F/C Port Seal	Ethylene Propylene
HEAD				
4	2	96158	Bearing Plate	6061-T6 Aluminium alloy - Hard anodized
5	2	96160	Sealing Plate	Engineering Thermoplastic.
6	2	96162	Permeate Port	Engineering Thermoplastic.
7	2	45066	Port Nut	Engineering Thermoplastic.
8	2	96000	Head Seal	Ethylene Propylene - O - Ring
9	2	45312	Perm Port Seal	Ethylene Propylene - O - Ring
HEAD INTERLOCK				
10	2	47336	Quick Release Spiral Ring	316 Stainless Steel.
VESSEL SUPPORT				
11	* 2	52169	Saddle	Engineering Thermoplastic.
12	* 2	45042	Strap Assy.	304 Stainless Steel-PVC Cushion.
13	4	46265	Strap screw.	5/16-18 UNC, 18-8 Stainless Steel.
ELEMENT INTERFACE				
14	2	A/R	Adapter	Engineering Thermoplastic.
15	2	52245	Adapter seal	Ethylene Propylene - O - Ring
16	4	A/R	PWT Seal	Ethylene Propylene - O - Ring
17	1	96163	Thrust Cone	Engineering Thermoplastic.

* 3 each furnished with length code 4,5,6,7 & 8.

CodeLine™
Pentair Water

CODILINE - 80S100
MEMBRANE HOUSING

DRAWN DATE	PGS 02 SEP 05	ECN 1725	DWG. NO.	99163	REV. F
CHECKED DATE	MD 02 SEP 05		DATE	30 DEC 09	SCALE NONE
APPROVED DATE	RM 02 SEP 05				SHEET 1 OF 2

4 3 2 1

